

# Safety Instructions



October 2020

## Find Francazal Airport

SAFIRE is located on Toulouse Francazal Airport, located in the town of Cugnaux, south - west of Toulouse (direction Tarbes)

- **CNRS SAFIRE**  
**Aéroport de Toulouse Francazal**  
135 avenue du Comminges –  
BP 20034 - 31270 Cugnaux, FRANCE

Access by car

Take the A64 towards Tarbes

Take exit n° 37 (Cugnaux)

Follow Francazal Toulouse Airport  
(entrance at 135 Avenue of Comminges)

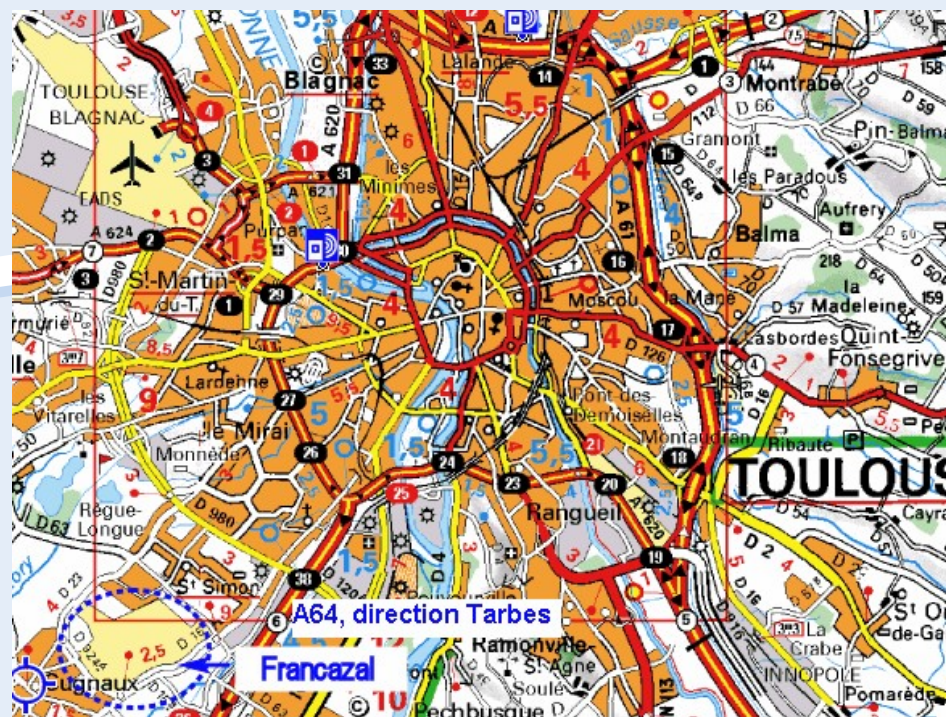

# Safety Instructions : FA20

## Find SAFIRE on the airport

- Since you enter a restricted area, the access requires to call the secretary to open the entry gate.

At the entrance, stop in front of the entryphone located 5 meters before the access gate  
Scroll through the names and ring on "CNRS SAFIRE"  
"CNRS SAFIRE" to call for opening.

**Or call 05-34-57-23-23**  
**desk@safire.fr**



- Take the road in front of you (slightly to the left) and continue straight until you see the SAFIRE hangar on the right side of the lane (just after the ATR building).
- Ring at the turnstile to get opened and report to the reception.

## Airport area

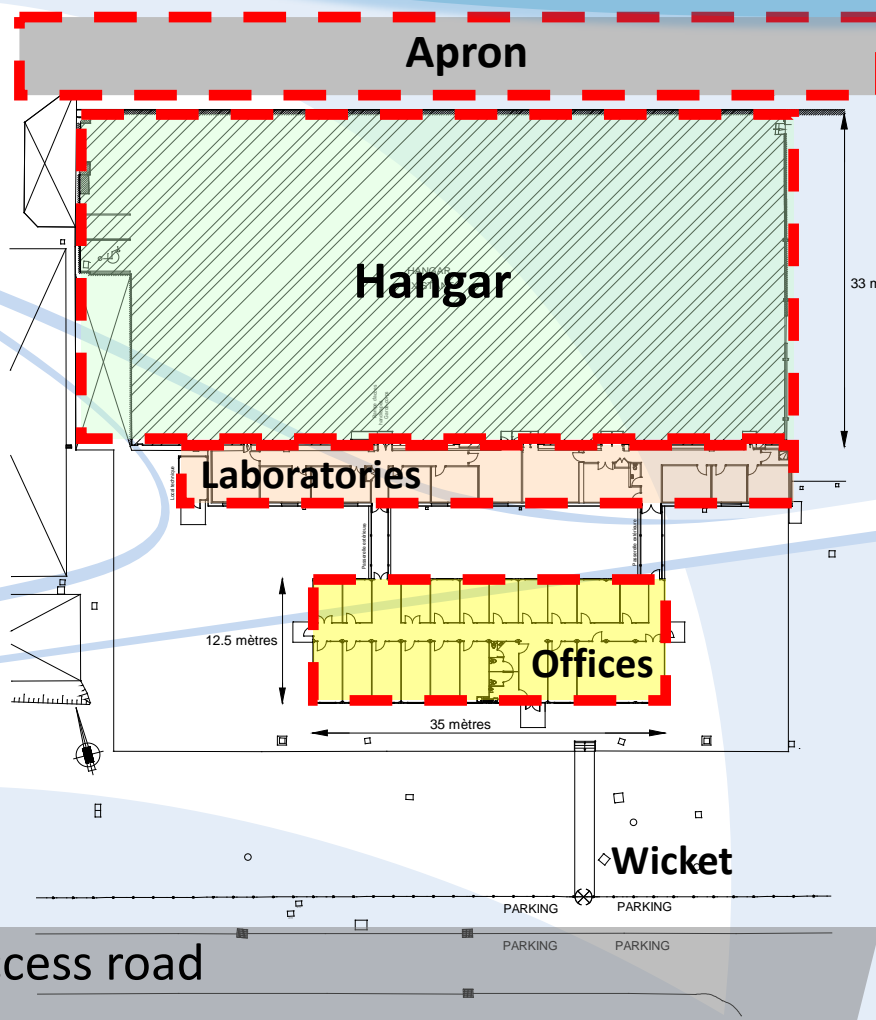

### Restricted area

- **Circulation in restricted area**

Offices and laboratories :

- pedestrians : access by wicket

Hangar

- pedestrians : access by offices and laboratories
- vehicles : restricted access by apron

**It is mandatory to be accompanied by a person of SAFIRE**



**For safety reason, hangar and laboratories are **NO-SMOKING AREAS****

Access road

PLAN RDC

## Airport area

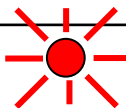
- Circulation in restricted area : **Apron**
  - pedestrians : fluorescent waistcoat is required
  - vehicles : access restricted :
    - **It is Mandatory to be accompanied by a person of SAFIRE** 
    - **Priority is always given to all aircraft moving**
    - **Pay attention with the meaning of the aircraft lights**

LIGHTS	MEANING
Navigation lights :  Red and green on the wing tips , white on the rear tail cone	Aircraft under voltage
Beacon lights : blinking red 	Aircraft about to start the engines
Taxi lights :  White on the nose landing gear	Aircraft taxiing

## Near the Aircraft

- **In the hangar :**

Prohibited areas are marked out by chains or red and white cones



**It is not allowed to  
penetrate in the  
marked out zones**

# Safety Instructions : FA20

## Near the Aircraft

- **On the apron :**

Prohibited areas are marked out by chains or red and white cones



**It is not allowed to  
penetrate in the  
marked out zones**

# Safety Instructions : FA20

## Near the aircraft

- **Auxiliary Power Unit (APU) :**



**When the APU is running :  
It is forbidden to approach  
the right rear part of the  
aircraft**



# Safety Instructions : FA20

## Access on board

- Access on board can only be done accompanied by one person of **SAFIRE**.
- The main access is the left front door provided with a staircase.



**People not belonging to  
SAFIRE cannot remain  
alone on board.**

## Access on board

- **Only people of SAFIRE are authorized to handle the doors of the aircraft.**



All device and material must be declared at SAFIRE before to be loaded in the aircraft.

In particular sensitive or dangerous goods such as gas or battery ...



## Access on board

- For any flight, all crew must have:
  - A valid mission order
  - A valid passports or ID, valid visas if necessary
  - Vaccinations so necessary
  - Any means of payment, credit card and/or cash.

## Life on board

- Hierarchy on board
  - the Captain, on the left seat in the cockpit
  - the First Officer, on the right seat of the cockpit.
  - the SAFIRE main experimenter seated in the center of the cabin
  - The SAFIRE experimenter seated in the cabin (if present)
  - The scientists
- The SAFIRE experimenter is in charge of the activity and safety in the cabin :
  - He organizes the communication between cockpit and cabin
  - He checks with the scientists the knowledge and the comprehension of the safety instructions
  - He organize the evacuation of the aircraft if ordered by the Captain

## Life on board

- The whole crew has to be present on board and ready for departure **at least 30 minutes** ahead of the start up of the engines
- **All communications are on the same loop : before asking for a request watch out the sign to know the com status**

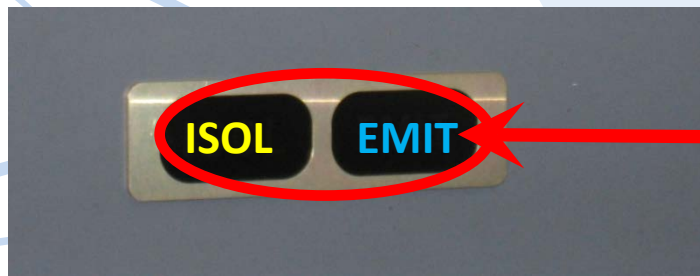

**ISOL**

Cabin and cockpit are isolated

**EMIT**

Cockpit is transmitting by radio

- Any request to the cockpit must be done through the main experimenter.
- It's always **prohibited to smoke** on board.
- There is **no toilets on board**, so please plan ahead.

## Safety Instructions



Seatbelts must be fasten during the phases of rolling, take off and landing and each time the lighting instructions are on

- It's recommended to keep your seatbelt fasten as long as you don't have to move in the cabin

## Safety Instructions

- Lighting instructions :

- Fasten your seatbelt

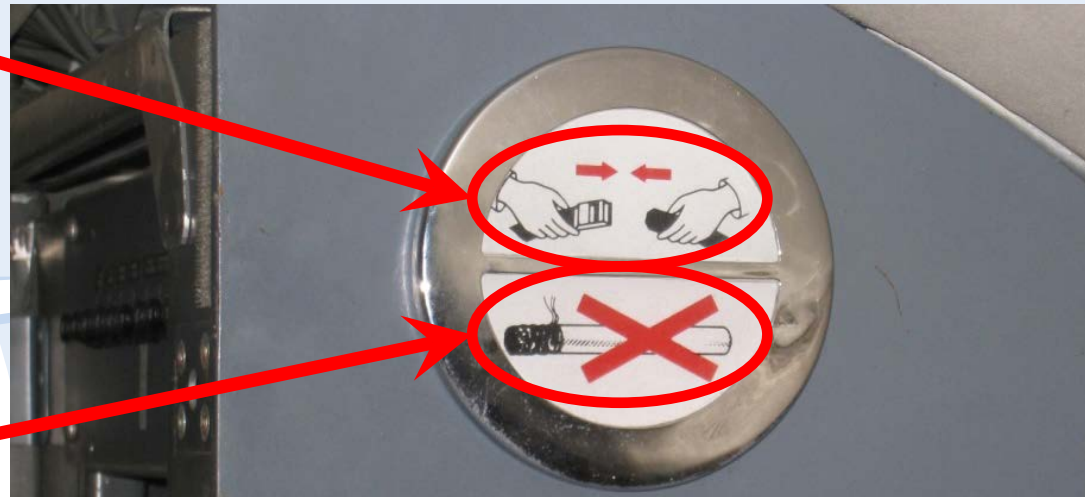

- No smoking

## Safety Instructions

- Safety cards describing escape routes on board are available at each workstation.

The emergency evacuation will be initiated by the main experimenter on order of the Captain

It will be made compulsorily by the indicated exit

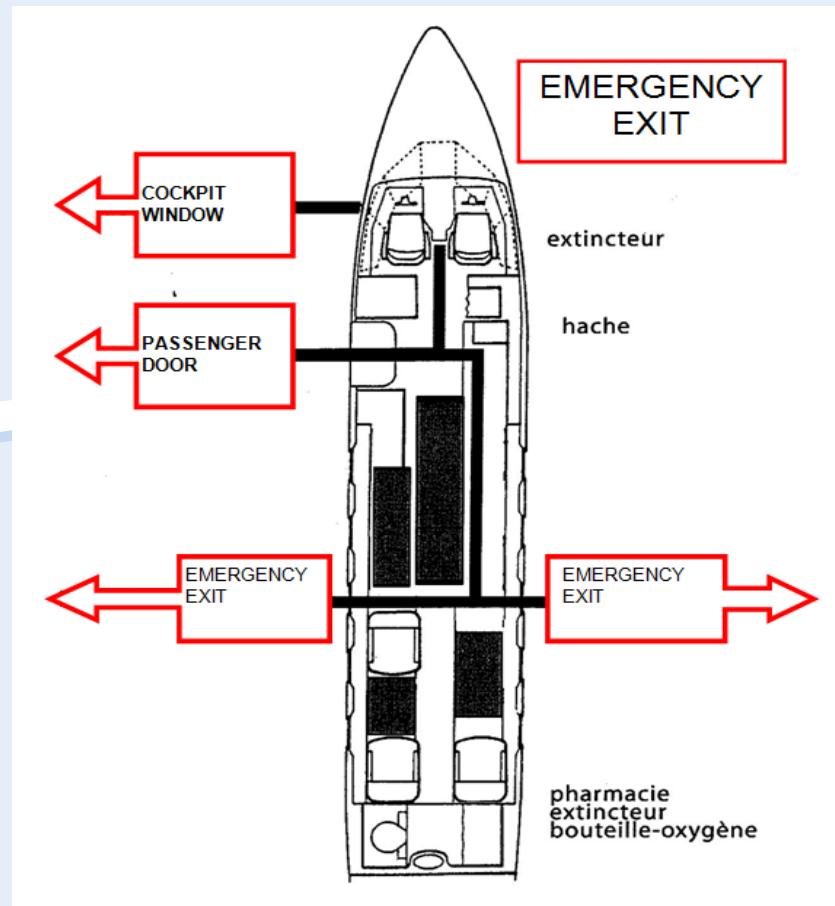



## Safety Instructions

- Emergency exits doors :

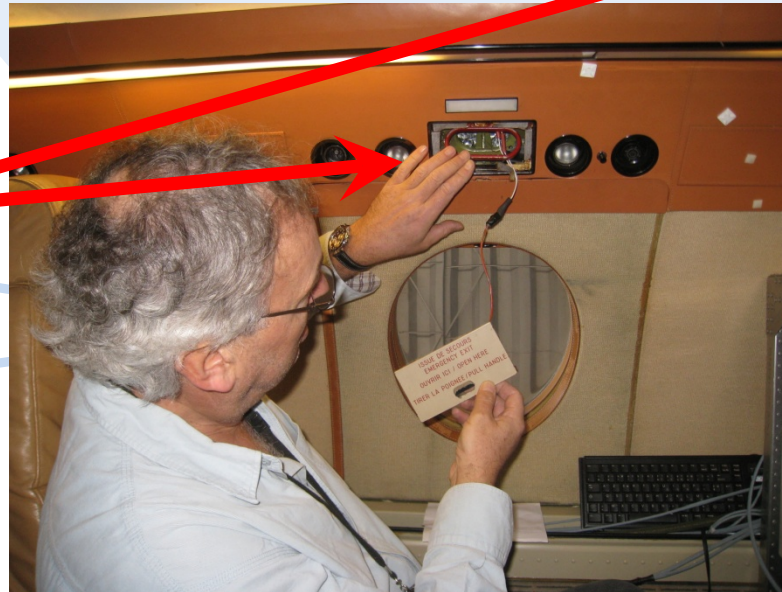

The opening of the emergency exit must only be operated by the main experimenter or the pilots.

## Safety Instructions

- The life jackets are under each seat
- Put on the life jacket only when ordered by one of the pilots or the main experimenter.
- The inflation of the life jacket must be done imperatively **outside of the aircraft.**



## Safety Instructions

- In the event of depressurization, the main experimenter will distribute oxygen masks and will help you to fit your mask
- Maintain the mask on your face using the elastic strap behind your head.
- Breathe normally



## Safety Instructions

- Safety position in case of emergency landing :
  - Keep your table IN
  - Fasten your seat belt tightly
  - Keep your hands on your knees
  - Hold your head on your chest



## Safety Instructions

- The use of the extinguisher is strictly reserved to the main experimenter and/or the pilots

Cockpit

Cabin



## Safety Instructions

- PED Lithium Battery Fire Handling

**WARNING**

DO NOT ATTEMPT TO PICK UP OR MOVE A SMOKING OR BURNING PED  
DO NOT COVER A SMOKING OR BURNING PED  
DO NOT USE ICE TO COOL A SMOKING OR BURNING PED

- Inform the captain
- Displace the passengers and move other PEDs away from the danger area
- Unplugged the concerned PED
- Put on Protective Breathing Equipment (PBE)
- Put on appropriated **protective gloves** (if available on board)
- Extinguish the fire, using the halon portable extinguisher
- Douse the Ped with water or any other non alcoholic liquid **when fire is extinguished**
- Contain the fire and monitor the fire area after extinguishment
- Keep the captain informed and follow his instructions
- When the fire is extinguished and the PED has cooled down, put the PED into a **fire containment bag** (if available on board).

# Safety Instructions : FA20

## Safety Instructions



- It's recommended **not to stay on board while refueling** is in progress.
- However, if you have to remain on board, **do not fasten your seat belt** and **be ready to evacuate** if necessary.

- Any violation of the safety instructions rules can involve a suspension of flight autorisation pronounced by the direction of SAFIRE